

śruba nierdzewna motylkowa

DIN: 316, PN 82436.

UWAGI:

- A2
- A4

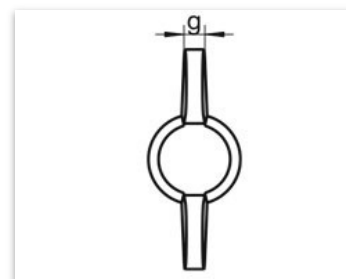
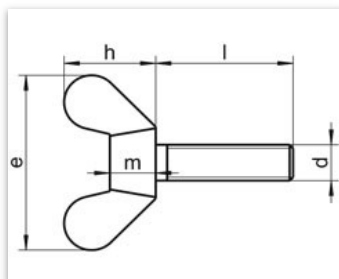

e	18	24,0	30,0	36,0	48,0	62,0
h	8,5	11,0	15,0	18,0	23,0	31,0
m	3,2	4,0	5,0	6,5	8,0	10,0
g	1,6	2,1	2,5	2,8	3,3	4,5
<b>L/∅</b>	<b>M4</b>	<b>M5</b>	<b>M6</b>	<b>M8</b>	<b>M10</b>	<b>M12</b>
10	●	●	●			
12	●	●	●			
14						
16	●	●	●	●	●	
18						
20	●	●	●	●	●	
22						
25	●	●	●	●	●	
30	●	●	●	●	●	●
35		●	●	●		
40		●	●	●	●	
45						
50			●	●		●
55						
60				●		