

podkładka nierdzewna okrągła poszerzona  
DIN 440, ISO 7094, PN 82019.

UWAGI:

- A2
- A4

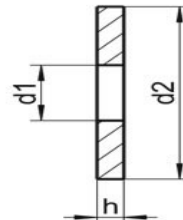
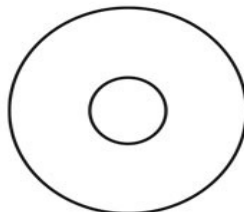

| d1   | do gwintu | d2 | h | A2/A4   |
|------|-----------|----|---|---|
| 5.5  | M5        | 18 | 2 | <span style="color: green;">●</span> <span style="color: red;">●</span> |
| 6.6  | M6        | 22 | 2 | <span style="color: green;">●</span> <span style="color: red;">●</span> |
| 9    | M8        | 28 | 3 | <span style="color: green;">●</span> <span style="color: red;">●</span> |
| 11   | M10       | 34 | 3 | <span style="color: green;">●</span> <span style="color: red;">●</span> |
| 13.5 | M12       | 44 | 4 | <span style="color: green;">●</span> <span style="color: red;">●</span> |
| 15.5 | M14       | 50 | 4 | <span style="color: green;">●</span> <span style="color: red;">●</span> |
| 17.5 | M16       | 56 | 5 | <span style="color: green;">●</span> <span style="color: red;">●</span> |
| 22   | M20       | 72 | 6 | <span style="color: green;">●</span> <span style="color: red;">●</span> |
| 24   | M22       | 80 | 6 | <span style="color: green;">●</span> <span style="color: red;">●</span> |
| 26   | M24       | 85 | 6 | <span style="color: green;">●</span> <span style="color: red;">●</span> |
| 30   | M27       | 98 | 6 | <span style="color: green;">●</span> <span style="color: red;">●</span> |

www.kastal.com.pl