

podkładka nierdzewna sprężysta
DIN 6796.

UWAGI:

- A2
- A4

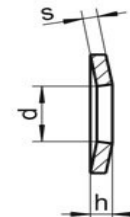
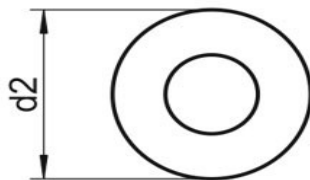

d	do gwintu	d2	h min	h max	s	A2/A4
3.0	M3	7	0.72	0.85	0.6	● ●
4.0	M4	9	1.12	1.30	1.0	● ●
5.0	M5	11	1.35	1.55	1.2	● ●
6.0	M6	14	1.70	2.00	1.5	● ●
8.0	M8	18	2.24	2.60	2.0	● ●
10.0	M10	23	2.80	3.20	2.5	● ●
12.0	M12	29	3.43	3.95	3.0	● ●
14.0	M14	35	4.04	4.65	3.5	● ●
16.0	M16	39	4.58	5.25	4.0	● ●
18.0	M18	42	5.08	5.80	4.5	● ●
20.0	M20	45	5.60	6.40	5.0	● ●
22.0	M22	49	6.15	7.05	5.5	● ●
24.0	M24	56	6.77	7.75	6.0	● ●

www.kastal.com.pl