

podkładka nierdzewna powiększona
DIN: 9021, ISO 7093, PN 82030.

UWAGI:

- A2
- A4

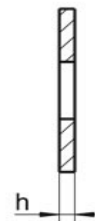
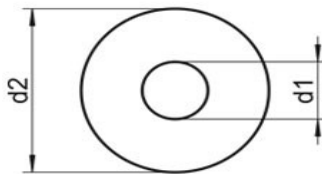

d	do gwintu	d2	h	A2/A4
2.2	M2	7	0.8	● ●
2.7	M2.5	8	0.8	● ●
3.2	M3	9	0.8	● ●
3.7	M3.5	11	0.8	● ●
4.3	M4	12	1.0	● ●
5.3	M5	15	1.2	● ●
6.4	M6	18	1.6	● ●
7.4	M7	22	2.0	● ●
8.4	M8	24	2.0	● ●
10.5	M10	30	2.5	● ●
13.0	M12	37	3.0	● ●
15.0	M14	44	3.0	● ●
27.0	M16	40	3.0	● ●
20.0	M18	56	4.0	● ●
22.0	M20	60	4.0	● ●
26.0	M24	72	5.0	● ●
33.0	M30	92	6.0	● ●
39.0	M36	110	8.0	● ●

www.kastal.com.pl