

nit zrywalny alu-stal
CZARNY RAL 9005
nitalustalczarny

UWAGI:

- A2
- A4
- Alu.
- Stal

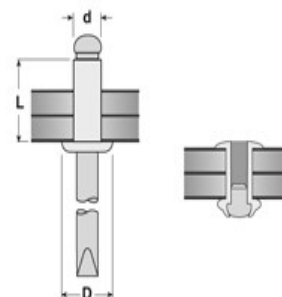
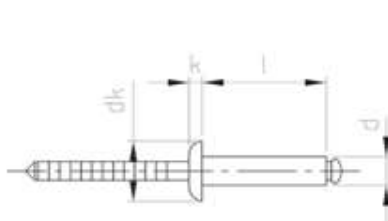

d	l	dk	k	kl	s	z	Alu	Stal
3	6	6	3.1	1.0-3.0	880	640	●	●
	8			3.0-5.0			●	●
	10			5.0-7.0			●	●
	12			7.0-9.0			●	●
3.2	6	6.5	3.3	1.0-3.0	950	680	●	●
	8			3.0-5.0			●	●
	10			5.0-7.0			●	●
	12			7.0-9.0			●	●
4	6	8	4.1	1.0-2.0	1850	1300	●	●
	8			2.0-4.0			●	●
	10			4.0-6.0			●	●
	12			6.0-8.0			●	●
	14			8.0-10.0			●	●
	16			10.0-12.0			●	●
	18			12.0-14.0			●	●
	20			14.0-16.0			●	●
4.8	8	9.5	5	3.0-4.0	2950	2170	●	●
	10			4.0-5.0			●	●
	12			6.0-7.0			●	●
	14			7.0-9.0			●	●
	16			9.0-11.0			●	●
	18			11.0-13.0			●	●
	20			13.0-15.0			●	●