

nit stożkowy
aluminiowo/stalowy
nitstozalustal

UWAGI:

- A2
- A4
- Alu.
- Stal

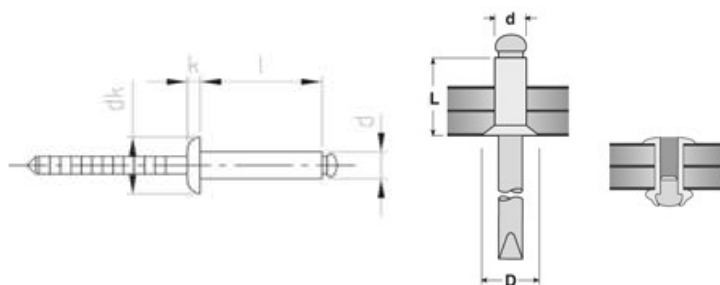

d	l	dk	k	kl	s	z	Alu	Stal
3.2	8	6	3.3	2.0-5.0	950	680	●	●
	10			5.0-7.0			●	●
	12			7.0-9.0			●	●
	14			9.0-11.0			●	●
4	8	7.5	4.1	3.0-5.0	1850	1300	●	●
	10			5.0-7.0			●	●
	12			7.0-9.0			●	●
	14			9.0-11.0			●	●
	16			11.0-13.0			●	●
	18			13.0-15.0			●	●
4.8	8	9	5	3.0-4.0	2950	2170	●	●
	10			4.0-6.0			●	●
	12			6.0-8.0			●	●
	14			8.0-10.0			●	●
	16			10.0-12.0			●	●
	18			12.0-14.0			●	●
	20			14.0-16.0			●	●